

Rollerball 0160A 0160B

Operator's Manual



BEFORE USING

0160A	AC 100~120V	50/60Hz	900/1100W	<input type="checkbox"/>
0160A	AC 220~240V	50/60Hz	900/1100W	<input type="checkbox"/>
0160B	AC 100~120V	50/60Hz	900/1100W	<input type="checkbox"/>
0160B	AC 220~240V	50/60Hz	900/1100W	<input type="checkbox"/>

To get the best results out of Rollerball and to make customers feel comfortable under Rollerball, please follow steps illustrated hereunder.

Step 1



- Adjust the height of Rollerball by moving sliding pipe up or down to place the guide bar at the center of customer's rear neck.
- Distance between the neck and the guide bar should be 5cm.
- In case of arm type Rollerball, place Rollerball by grabbing grip. Do not grab by the ring to move Rollerball.

Step 2

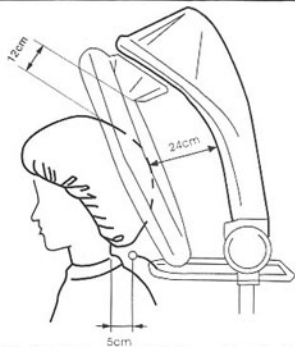

Rollerball should be adjusted and placed;

- 12cm (5") at the pivot from the top of head.
- 5cm (2") at the position guide from rear of the neck.

Step 3

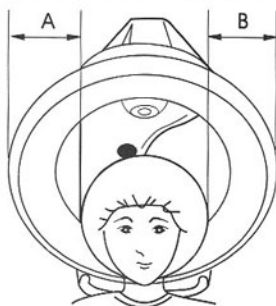

Distances of A and B should be about the same.

ADJUSTING ANGLE OF NAPE FAN

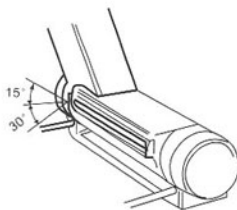

Angle of nape fan is adjustable to suit to length of hair or hair stylist's technique. Turn angle adjuster knob to tilt upwards upto 15 degree and downwards upto 30 degree.

CONTROL PANEL

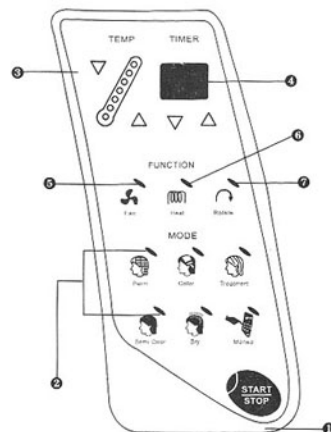

1 Start/Stop (SS) key

Push this key to start and also to interrupt the operation.

2 Mode selection keys

For the selection of mode; Perm, Color, Treatment, Semi permanent color, Dry and Manual modes are provided.

3 Temperature level key

Heating temperature can be changed in seven levels 1-7 starting from the bottom.

4 Timer key

Operation time can be changed in increments of one minute with a push of button. Pushing of button for more than one second will change in five minutes increments.

5 Nape fan (on-off) key

Push this key to start and stop nape fan.

6 Fan heater

For the selection of hot or cold air by nape fan. Only available when nape fan is on.

7 Ring rotation key

For on an off rotation of circular heater. Only available when the operation is on Dry or Manual mode.

Mode	Application	Prefixed Functions						Temperature controlled by
		Temperature level	Timer	Fan on/off	Heater	Rotation	Cooling Time	
Perm	Used for perm. Adjust time and heat level to suit to type of lotion, conditions of hair, and technique of hairdresser.	3	7 min.	OFF	OFF	ON		By infra-red thermometer
		Adjustable according to the conditions and method.						
Color	Used for coloring (hair dye) Adjust time and heat level to suit to type of dye, conditions of hair, and technique of hairdresser.	3	10 min.	OFF	OFF	ON		
		Adjustable according to the conditions and method.						
Treatment	Used for treatments. Adjust time and heat level to suit to type of lotion and conditions of hair.	4	10 min.	OFF	OFF	ON		
		Adjustable according to the conditions and method.						
Semi (Permanent) Color	Used for semi permanent color and acid type hair dye. Adjust time and heat level to suit to the type of semi permanent color lotion and acid type hair dye.	5	10 min.	OFF	OFF	ON		
		Adjustable according to the conditions and method.						
Dry	Used for drying and natural look styling hair and iron perm.	6	15 min.	ON	ON	ON		By programmed interval ON/OFF of heating.
		Adjustable according to the conditions and method. Rotation can be stopped at where needed.						
Manual	Versatile mode for all techniques and methods. Usable with ring rotation stopped at where needed.	3	10 min.	ON	ON	ON		
		Adjustable according to the conditions and method. Rotation can be stopped at where needed.						

OPERATION

1. Set the machine at the correct position

- See page 1 for positioning Rollerball.
- If Rollerball being not at a correct position, Rollerball will not perform at its optimum performance.

2. Push the power switch on

- All illumination except Mode selection keys and Start/Stop be lit and Rollerball is now ready. (Timer display shows 00.)

3. Select a mode

- Push a mode you desire.
- The mode selected will be illuminated, standard heat will be illuminated and time will be displayed.
- Adjust heat lever and time, if needed.

4. Push Start/Stop key to start

- The circular heater will rotate.
- Rollerball is operated by time and heat level programmed.

5. During Operation

- Illumination of Start/Stop key will stay on.
- Illumination of selected mode will stay on.
- Time decimals will blink at each second
 - < Changes during operation >
Changes except mode can be made during operation.
 - < Interruption during operation >
1 Press Start/Stop key to interrupt operation.
2 Rotation of circular heater will stop.
3 Illumination of Start/Stop ceeds off.
4 Illumination of mode will stay on.
5 Heat level display will change from on to on-and-off.
6 During interruption. changes including mode can be done.

6. Time Up

- When programmed time is up, electronic chime will sound.
- Cool air will come out from nape fan.
- After 2 minutes of cooling time, electronic chime will sound and stop operation.
 - < There will not be a cooling period in manual mode.>
 - After time-up, elapsed time from the end of operation will be shown at timer display.
 - Memory of last operation
Heat level and time of the last operation can be recalled by touching Start/Stop key with 60 minutes after end of operation. This function is useful when comparing result with program.

7. Turn off the power

ROTATION OF CIRCULAR HEATER AND ITS STOP

Circular heater rotates 5 times (at 60Hz) a minute around customer's head; (4 times at 50Hz). The unique rotation provides, without concentration of heat on the location, not only consistent temperature distribution, but also relaxing, mild, comfortable warmth to customers. In case additional heat is needed on a particular part of the head for hair perming, coloring and drying, halt circular heater at where needed and use manual or dry mode.

Relation of movement and heating of Circular Heater with the status of Rotation key.

Operation	Status of Rotation key			
	Key is ON. (Normal operation by prefixed modes, except for Dry and Manual Modes)		Key is OFF. (Rotation is stopped. In Dry and Manual Modes)	
	ROTATION	HEATER	ROTATION	HEATER
Under operation	Rotates.	ON	Stopped.	ON
When interrupted by Start/Stop key	Stop at when S/S key is touched.	ON	Stays still.	OFF
Re-started by S/S key after 5 minutes of interruption	Rotation starts.	ON	Stays still.	ON
Touching S/S key after 5 minutes of interruption.	Returns to original stop position.	OFF	Returns to original stop position.	OFF
During Cooling time.	Rotates.	OFF	Stays still.	OFF
Cooling time is over.	Returns to original stop position.	OFF	Returns to original stop position.	OFF

How to bring circular heater back to the Starting Position if the circular heater stays in the middle.

When the operation is interrupted for more than 5 minutes, the circular heater automatically rotates back to the Starting Position.

Rollerball's Self-Deagnosis-Warning System

For some reasons, malfunction takes place, Rollerball detected it and stops operation and returns to Stand-by mode by itself. This alarm will go on until power is off. Please turn off power immediately. If this phenomenon persists, please contact your local dealer.

Cautions

1. Rollerball is sensitive.

Rollerball has complex electronic parts like ones in computers. They are easily affected by extreme environment such as in cold outdoor or under summer sun light. Please avoid exposing at extreme hot or cold conditions.



2. Rollerball needs correct power source.

Rollerball needs at least 10A outlet for itself. Please connect Rollerball with correct outlet and do not share with other appliance.

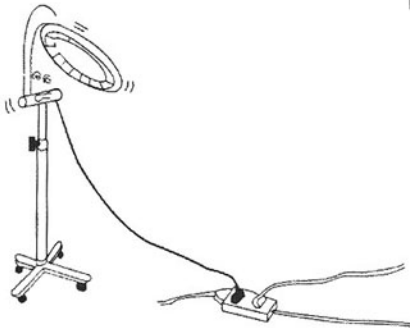

3. Do not disconnect the power plug by pulling the cable, Hold the plug and then pull.



4. Do not wet Rollerball.

Dry your hands first and then touch switch panels. Please keep Rollerball dry.

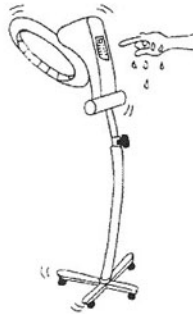

5. Do not halt the circular heater with hand unless emergency.

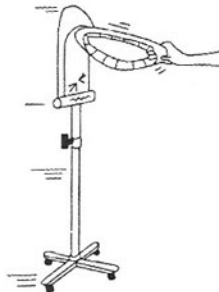

6. Do not move or lift Rollerball by grabbing circular heater with hand. This will damage parts.

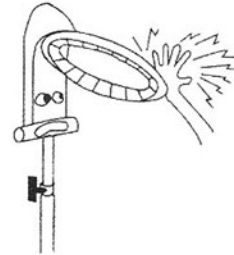

Maintenance

1. Use dry and soft cloth to clean plastics. Plated, and painted surface.
2. Dump cloth with neutral detergent and wipe to remove stubborn stains and dirt.
3. Use only mild neutral detergent.
4. Keep thermal sensor clean, otherwise Rollerball can not control temperature correctly.



Neutral detergent



Thinner or Benzene

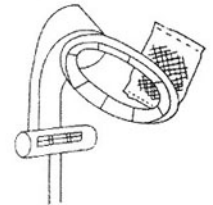

(STAND) 0160A INSTALLATION INSTRUCTIONS AND PARTS LIST

INSTALLATION INSTRUCTION

1. Place the UPPER FLANGE on the center of LEG ASSEMBLY
2. Put the POLE ASSEMBLY on the UPPER FLANGE.
(KNOB on POLE must be on LEFT side seen from front.)
3. Attach LOWER FLANGE from underneath of LEG ASSEMBLY with HEX BOLT, FLAT WASHER and SPRING WASHER.
(Use the WRENCH supplied.)
4. Attach INNER PIPE to ROLLERBALL HEAD ASSEMBLY with a SET SCREW.
5. Insert INNER PIPE to POLE ASSEMBLY.
Insure that ROLLERBALL HEAD is on INNER PIPE and facing front.
Line up Groove of INNER PIPE with KNOB SCREWS.

CAUTION!

DO NOT insert inner pipe alone into pole assembly, or inner pipe may pop out.
Strong spring tention in pole assembly may cause serious injury during installation or disassembly.

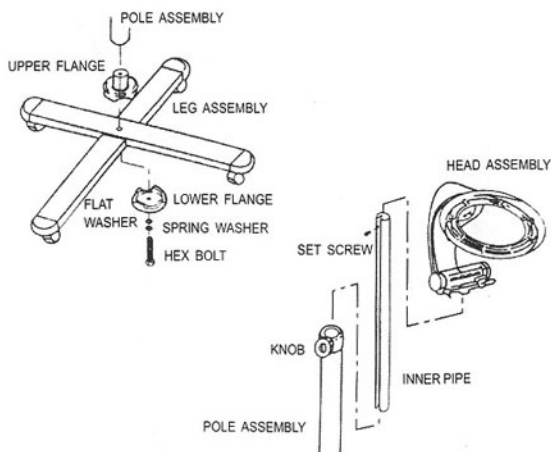

PARTS LIST

STAND ASSEMBLY (CRSA-01)

NO. DESCRIPTION PARTS NO.

LEG ASSEMBLY CRSA-02
1 LEGS CRS-001
2 CASTER CRS-002
3 END CAP FOR LEG CRS-003
4 NUT FOR END CAP CRS-004

FLANGE SET CRSB-02
5 UPPRR FLANGE CRS-005
6 LOWER FLANGE CRS-006
7 FLAT WASHER CRS-007
8 SPRING WASHER CRS-008
9 HEX BOLT CRS-009

POLE SET CRSC-02
10 POLE ASSEMBLY CRS-010
11 KNOB CRS-011
12 INNER PIPE CRS-012
13 SET SCREW CRS-013

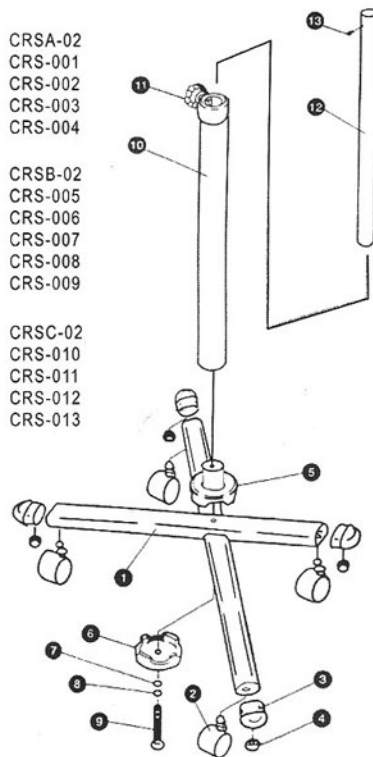

1. PRE-INSTALLATION

1-1 WALL

The wall must be sturdy enough to support the arm assembly and dryer/processor head.

1-2 HEIGHT

Recommended height of wall bracket is 1840/1950mm from floor to the bottom of the bracket. (Fig.1)

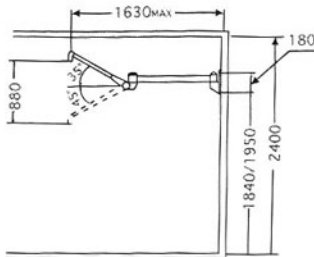

Fig.1

1-3 ELECTRIC SOURCE

An electrical outlet with proper power must be prepared on the wall at the distance within 500mm from the wall bracket.

2. INSTALLATION OF WALL PLATE AND WALL BRACKET

2-1 Using the wall plate as a template, drill two holes (10.5mm Dia./65mm DEEP) on wall.

IMPORTANT: Two holes must be perpendicular. (Fig.2)



Fig.2

2-2 Insert the anchor bolts (supplied) into the holes, then hammer the pin into the anchor bolt. (Fig.3)

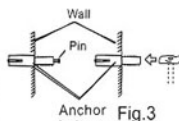

Fig.3

2-3 Placing the square neck flat head bolts to the wall plate as shown in Fig.4-a, attach the wall plate to the wall on anchor bolts, then fix it with nuts. (Fig.4-b)

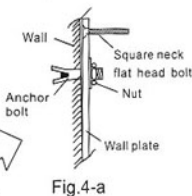

Fig.4-a

CAUTION!

As wall plate and wall bracket are subject to a large shear load, make sure that the wall plate is installed correctly and firmly.

2-5 Attach wall bracket over the square neck bolts, then tighten with plastic washers, steel washers and nuts. (Fig. 5)

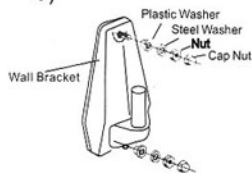

Fig.5

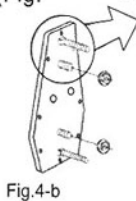

Fig.4-b

3. INSTALLATION OF ARM ASSEMBLY AND MACHINE HEAD

CAUTION!

DO NOT REMOVE STOPPER on Arm until machine head is completely installed. Arm assembly is spring loaded and could cause equipment damage and/or injury if not handled in a proper manner.

3-1 Put a steel washer over the stem of wall bracket, and mount the arm assembly on the stem. (Fig.6)



Fig.6

3-2 Remove the hook by loosening the screw. (Fig.7)

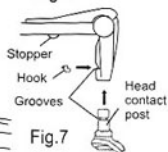

Fig.7

3-3 Insert head contact post into the tip of arm unit, the groove of post can be seen through the groove of the hook. (Fig.7)

3-4 Reinstall the hook into the groove and tighten firmly. (Fig.8)

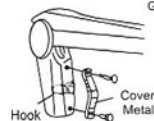

Fig.8

3-5 Attach cover metal over the hook. (Fig.8)

3-6 Remove stopper. (Fig.7)

3-7 Connect the cable to the outlet on wall.

4. ADJUSTMENT

4-1 Highest position adjustment. (Fig.9) If machine head hits the ceiling or other furniture, the highest position can be restricted.

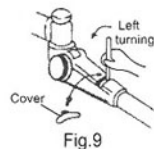

Fig.9

(A) Remove cover on balance arm.
(B) Turn the adjusting nut to left (seen from front) with supplied wrench.

4-2 Balance adjustment. (Fig.9) If balance arm drifts either higher or lower from the set position. Remove arm cover and turn the balance Adjusting nut. To + direction: More tension
To - direction: Less tension

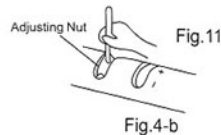
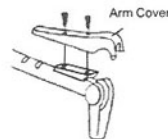
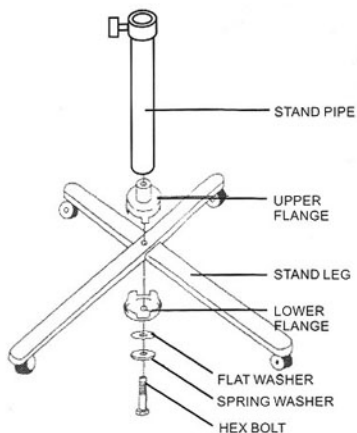

Fig.11

Fig.4-b

HOW TO ASSEMBLE DRYER STAND

HOW TO ASSEMBLE DRYER STAND



HOW TO ATTACH INNER PIPE TO DRYER HEAD

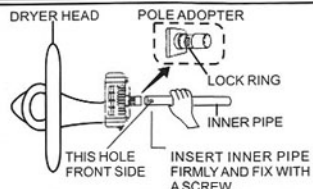

Place dryer head on a stable table and insert inner pipe to pole adapter.

NOTE: Lay a cloth on the table to protect the dryer head. Twisting inner pipe makes inserting easier. Do not take off lock ring.

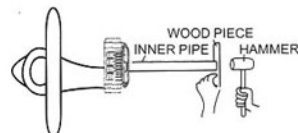

If inserting inner pipe is still difficult, tap the end of inner pipe with a plastic hammer or with a piece of wood and a hammer as shown above.

WARNING

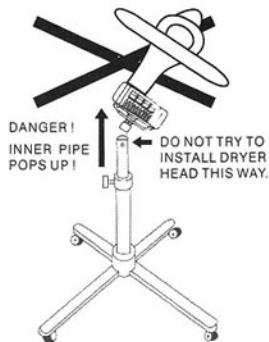

WARNING
Do not insert inner pipe alone in stand pipe. Inner pipe may pop out.

ASSEMBLY OF DRYER HEAD TO DRYER STAND

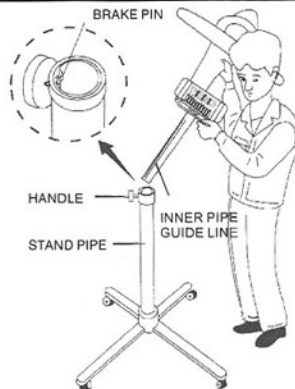

Loose handle. line up inner pipe guide line to brake pin and insert inner pipe with dryer head to stand pipe.

IDENTIFICATION

